

ACTUAL SIZE

CONNECTOR MATES WITH DYTRAN CABLE 6811AXX

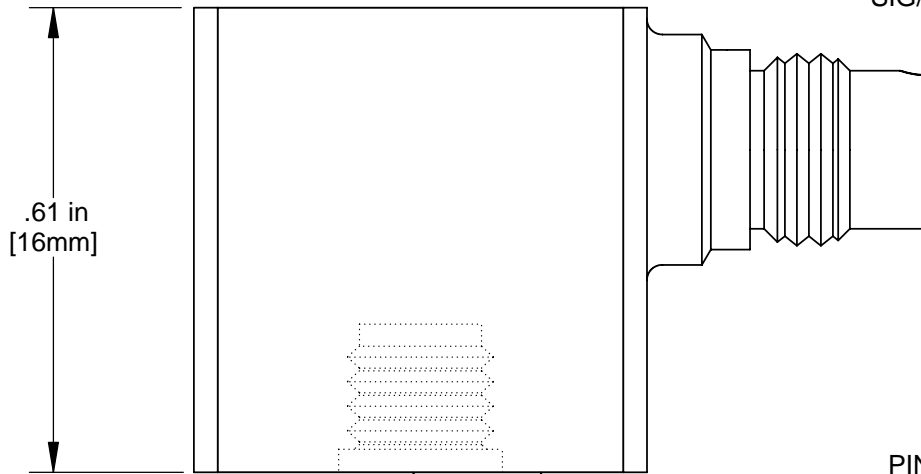

PIN 4
 SIG/PWR AXIS 1 (X)

PIN 1
 GND RETURN, COMMON

PIN 3
 SIG/PWR AXIS 3 (Z)

3 (+Z) AXIS

PIN 2
 SIG/PWR AXIS 2 (Y)

TAPPED HOLE 10-32 X .150 DEEP

MOUNTING SURFACE

5. MOUNTING SCREW (10-32 UNC-2B) MODEL 6200 ,PROVIDED

4. WEIGHT = 10 GRAMS

△ 3 XX = CABLE LENGTH IN FEET

2. + SIGNS INDICATE SENSITIVE AXIS AND DIRECTION OF INPUT ACCELERATION FOR POSITIVE GOING OUTPUT SIGNAL.

1. HOUSING MATERIAL TITANIUM 6AL-4V

EXCEPT AS OTHERWISE NOTED

ALL DIMENSIONS IN INCHES
 TOLERANCE: .XX = ± .01

DYTRAN
 INSTRUMENTS, INC.

CHATSWORTH, CA

SCALE 4:1	REV -	DATE -	ECN -		
DATE 9/3/2004	PART NO. MODEL 3093M8				
DRAWN P. Casucci	CHECKED R.A.	MATERIAL			
APPROVED	NEXT ASSEMBLY		USED ON 3093M8		
TITLE OUTLINE / INSTALLATION DRAWING MODEL 3093M8			DWG NO. 127-3093M8		
SHEET 1 OF 1					

SPECIFICATIONS
MODEL 3093M8 TRIAXIAL ACCELEROMETER WITH TEDS

SPECIFICATIONS	VALUE	UNITS
RANGE, F.S. (each axis, for ± 5 volts out)	± 50	G
SENSITIVITY, +15 -10% [1]	100	mV/G
FREQUENCY RESPONSE, +/- 10%	2 to 5000	Hz
ELEMENT NATURAL FREQUENCY	>30	kHz
DISCHARGE TIME CONSTANT	0.5 to 1.5	SEC
EQUIVALENT ELECTRICAL NOISE	.0007	G, RMS
LINEARITY [2]	1	%F.S.
TRANSVERSE SENSITIVITY, MAX,	5	%
OUTPUT BIAS VOLTAGE	+11 to +13	VDC
OUTPUT IMPEDANCE, TYP.	100	OHMS
TEMPERATURE RANGE	-60 to +225	$^{\circ}$ F
TEDS OPERATIONAL TEMPERATURE	-60 to +185	$^{\circ}$ F
COEFFICIENT OF THERMAL SENSITIVITY	.03	%/ $^{\circ}$ F
MAXIMUM VIBRATION	+/- 100	G
MAXIMUM SHOCK	3000	G
SIZE (HEIGHT x WIDTH x DEPTH)	0.61 x .59 x .59	INCHES
WEIGHT	10.0	GRAMS
CONNECTOR	4-PIN [3]	
SUPPLY CURRENT RANGE, (each axis) [4]	2-to 20	mA
COMPLIANCE (SUPPLY) VOLTAGE RANGE (each axis)	+18 to +30	VDC
MATERIAL, HOUSING/CONNECTOR	6AL-4V	TITANIUM
ENVIRONMENTAL SEAL	HERMETIC	
MOUNTING [5]	10-32 UNC-2B	
GROUND ISOLATION	10, MIN.	MEGOHMS
IEPE SENSOR WITH TEDS FEATURE	PER IEEE 1451.4	

[1] Reference sensitivity measured at 100 Hz, 1 G RMS per ISA RP 37.2

[2] Linearity is % of specified full scale (or any lesser full-scale range), zero-based best-fit straight-line method.

[3] Connector mates with Dytran cable assy. Model 6811Axx. (xx = length in feet)

[4] Power only with Dytran LIVM power unit or other Dytran-compatible constant current type power unit. If power is applied without current limiting protection, the internal amplifier will be immediately destroyed.

[5] Case ground isolation is achieved by internal means.