

- 2. MOUNTING TORQUE ON .281 HEX: 3 TO 4 LB.-IN.
- 1. WEIGHT: 2.5 GRAMS.

		<b>MASTER</b>		CHATSORTH, CA.	
<b>ONLY IF IN RED</b>					
SCALE	4X	REV	A	DATE	6/10/04
DATE	11/15/99	PART NO.	MODEL 3035C		
DRAWN	N.C.	CHECKED	R.A.	MAT'L	
APPROVED			NEXT ASSEMBLY	USED ON	
TITLE				DWG NO.	
OUTLINE/INSTALLATION DRAWING, MODEL 3035C CHARGE MODE ACCELEROMETER, NEGATIVE OUTPUT				127-3035C	
				SHEET 1 OF 1	

**IEPE ACCELEROMETER**

REV A, ECN 11126, 07/7/14

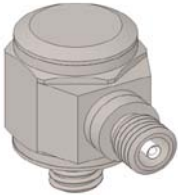

- MINATURE SIZE
- HERMETICALLY SEALED
- STUD MOUNT

**PHYSICAL**

Weight, Max.  
Connector  
Mounting Provision  
Material, Housing/Connector  
Sensing Element  
Element Style

ENGLISH		SI	
0.09	oz	2.5	grams
5-44 Coaxial		5-44 Coaxial	
5-40 Integral Stud		5-40 Integral Stud	
300 Series Stainless Steel		300 Series Stainless Steel	
Ceramic		Ceramic	
Shear		Shear	

**PERFORMANCE**

Sensitivity, ±10% [1]  
Range for ± 5 Volts Output  
Frequency Response, ±10%  
Resonant Frequency  
Linearity [2]  
Maximum Transverse sensitivity  
Strain Sensitivity @ 250µε

2.5	mV/g	0.3	mV/m/s <sup>2</sup>
±500	g	±4905	m/s <sup>2</sup>
0.5 to 10000	Hz	0.5 to 10000	Hz
> 45	kHz	> 45	kHz
±1	% F.S.	±1	% F.S.
5	%	5	%
0.002	g/µε	0.02	m/s <sup>2</sup> /µε

**ENVIRONMENTAL**

Maximum Vibration  
Maximum Shock  
Temperature Range  
Seal  
Electrical Isolation

600	Gpeak	5884	m/s <sup>2</sup> peak
10000	Gpeak	98067	m/s <sup>2</sup> peak
-100 to +400	°F	-73 to +204	°C
Hermetic		Hermetic	
Case Grounded	GΩ,min	Case Grounded	GΩ,min

**This family also includes:**

Model	Range F.S. (g)	Sensitivity (mV/g)	Time Constant (Sec)

Refer to the performance specifications of the products in this family for detailed description

**Supplied Accessories:**

- 1) Accredited calibration certificate (ISO 17025)

**Notes:**

- [1] Measured at 100Hz, 1 Grms per ISA RP 37.2.
- [2] Measure using zero-based straight line method, % of F.S. or any lesser range.
- [3] In the interest of constant product improvement, we reserve the right to change specifications without notice.

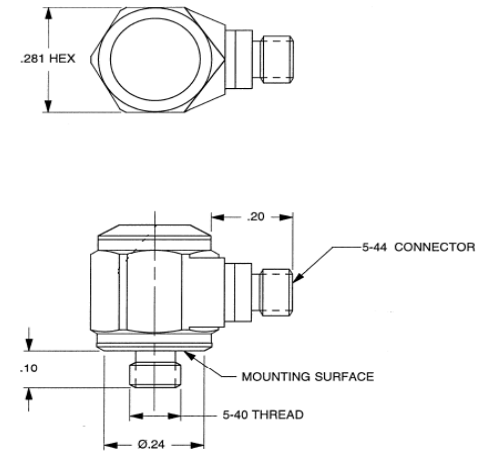
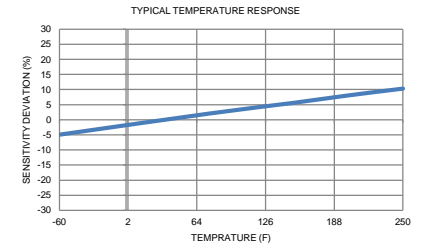
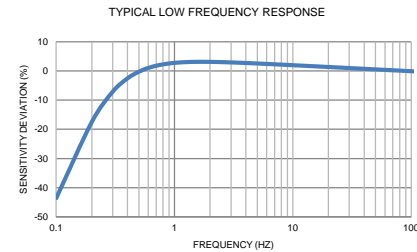

Units on the line drawing are in inches, units in brackets are in millimeters. Refer to 127-3035C for more information.



21592 Marilla Street, Chatsworth, California 91311 Phone: 818.700.7818 Fax: 818.700.7880 www.dytran.com  
For permission to reprint this content, please contact info@dytran.com



Presented by: Absolute Gauge Technologies  
sales@absolute-gauge.com; www.absolute-gauge.com,  
Toronto: 416 754 3168, Montreal: 514 695 5147, Toll Free: 1 888 754 7008