

<b>PROPRIETARY AND CONFIDENTIAL</b>		REVISIONS					
THE INFORMATION CONTAINED IN THIS DRAWING IS THE SOLE PROPERTY OF DYTRAN INSTRUMENTS INC. ANY REPRODUCTION IN PART OR AS A WHOLE WITHOUT THE WRITTEN PERMISSION OF DYTRAN INSTRUMENTS, INC. IS PROHIBITED		REV.	ECN	DESCRIPTION	BY/DATE	CHK	APPR
		A	9343	REDRAWN TO CURRENT DYTRAN STANDARDS	JS 11/08/12	AB	<i>[Signature]</i>

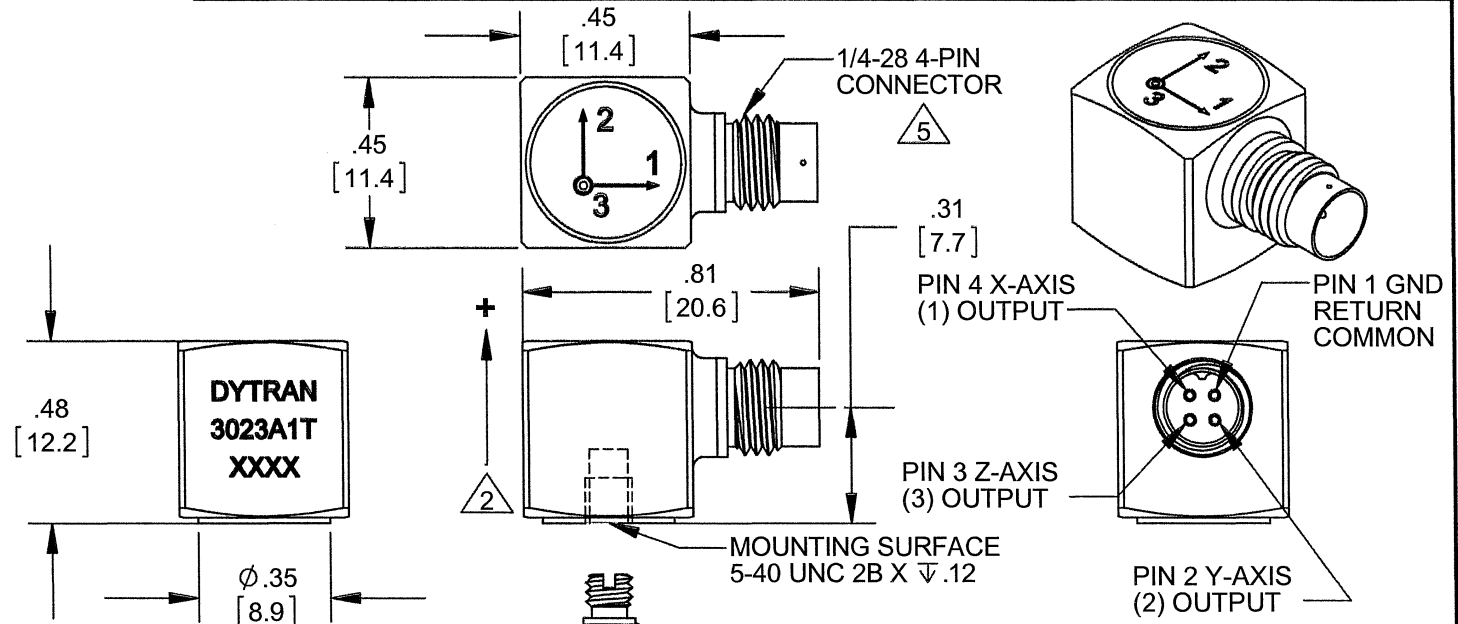

- △ 6 RECOMMENDED MOUNTING TORQUE 6-8 lb-in.
- △ 5 MATES WITH DYTRAN 6811AXX OR 6824AXX CABLE (XX= LENGTH IN FEET)
- 4. SENSITIVITY: 10mV/g NOMINAL
- 3. WEIGHT: 6.2 GRAMS NOMINAL.
- △ 2 ARROWS INDICATE ACCELERATION DIRECTION FOR POSITIVE OUTPUT
- 1. MATERIAL: TITANIUM ALLOY

**MOUNTING RECOMMENDATIONS:**  
 PREPARE SURFACE AT LEAST Ø.30 [7.5]  
 SURFACE FLATNESS MUST BE EQUAL OR BETTER THAN .001 TIR. TAP 5-40 UNC-2B ∇ .120 MIN

NOTES: UNLESS OTHERWISE SPECIFIED

USED ON	NEXT ASSY
APPLICATION	
THIRD ANGLE PROJECTION USA	

UNLESS OTHERWISE SPECIFIED:  
 INTERPRET DIM & TOL PER ASME Y14.5M - 1994.  
 REMOVE BURRS.  
 COUNTERSINK INTERNAL THDS 90° TO MAJOR DIA.  
 CHAM EXT THDS 45° TO MINOR DIA.  
 THD LENGTHS AND DEPTHS ARE FOR MIN FULL THDS.  
 THDS PER MIL-S-7742.  
 DIMENSIONS APPLY AFTER FINISHING.  
 ALL MACHINED SURFACES.  
 TOTAL RUNOUT WITHIN .005.  
 BREAK SHARP EDGES .005 TO .010.  
 MACHINED FILLET RADII .005 TO .015.  
 WELDING SYMBOLS PER AWS A2.4.  
 ABBREVIATIONS PER MIL-STD-12.

UNLESS OTHERWISE SPECIFIED:  
 DIMENSIONS ARE IN INCHES. DIMENSIONS IN BRACKETS [ ] ARE IN MILLIMETERS  
 TOLERANCES ARE:  
 INCHES    METRIC    ANGLES  
 .XX ± .03    .X ± 0.8    ± 1°  
 .XXX ± 0.10    .XX ± 0.25

MATERIAL

FINISH

DO NOT SCALE DRAWING

CONTRACT NO.		
APPROVALS		DATE
ORIG	JS	11/08/12
CHK		
APP		
APP		

<b>ONLY IF IN RED</b>			
TITLE: <b>OUTLINE DRAWING, 3023A1T TRIAXIAL ACCELEROMETER, TEDS</b>			
SIZE	CAGE CODE	DWG. NO.	REV
<b>A</b>	<b>2W033</b>	<b>127-3023A1T</b>	<b>A</b>
SCALE: 2:1		SOLIDWORKS	SHEET 1 OF 1

<b>Model Number</b> 3023A1T	<b>PERFORMANCE SPECIFICATIONS</b>	<b>DOC NO</b> PS3023A1T
	TRI AXIAL IEPE ACCELEROMETER	REV-A, ECN-11041,05/28/2014

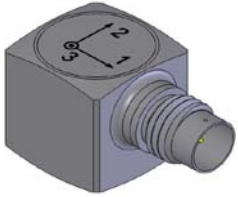

- STUD MOUNT
- EXCELLENT LINEARITY
- ULTRA LOW WEIGHT
- TEDS FEATURE

**PHYSICAL**

Weight, Max.  
Connector  
Mounting Provision  
Material, Housing/Connector  
Sensing Element  
Element Style

ENGLISH		SI	
0.22	oz	6.2	grams
4- PIN		4- PIN	
5 - 40 Tapped Hole		5 - 40 Tapped Hole	
Titanium Alloy		Titanium Alloy	
Quartz		Quartz	
Shear		Shear	

**PERFORMANCE**

Sensitivity, -10 / +15% [1]  
Range for ± 5 Volts Output  
Frequency Response  
Resonant Frequency  
Broad Band Resolution  
Spectral Noise  
Linearity [2]  
Maximum Transverse Sensitivity  
Strain Sensitivity @ 250µε

10	mV/g	1	mV/m/s <sup>2</sup>
±500	g	±4903	m/s <sup>2</sup>
1.5 to 4000	Hz	1.5 to 4000	Hz
±5% -5 / +15%		1.5 to 10000	Hz
> 40	kHz	> 40	kHz
0.007	Grms	0.069	m/s <sup>2</sup> rms
1.25Hz	µGrms/v(Hz)	0.029	µm/s <sup>2</sup> rms/v(Hz)
10Hz	µGrms/v(Hz)	0.0098	µm/s <sup>2</sup> rms/v(Hz)
100Hz	µGrms/v(Hz)	0.00196	µm/s <sup>2</sup> rms/v(Hz)
1000Hz	µGrms/v(Hz)	0.00049	µm/s <sup>2</sup> rms/v(Hz)
10000Hz	µGrms/v(Hz)	0.00039	µm/s <sup>2</sup> rms/v(Hz)
1	% F.S.	1	% F.S.
5	%	5	%
0.006	g/µε	0.06	m/s <sup>2</sup> /µε

**ENVIRONMENTAL**

Maximum Vibration  
Maximum Shock  
Temperature Range  
TEDS Operating Temperature  
Seal

±600	Gpeak	±5884	m/s <sup>2</sup> peak
5000	Gpeak	49033	m/s <sup>2</sup> peak
-60 to +250	°F	-51 to +121	°C
-60 to +185	°F	-51 to +85	°C
Hermetic		Hermetic	

**ELECTRICAL**

Supply Current Range [3]  
Compliance Voltage Range  
Output Impedance, Typ  
Bias Voltage  
Discharge Time Constant  
Electrical Isolation  
TEDS Feature

2 to 20	mA	2 to 20	mA
18 to 30	Volts	18 to 30	Volts
100	Ω	100	Ω
7 to 9	VDC	7 to 9	VDC
0.3 to 1.5	Sec	0.3 to 1.5	Sec
Case Grounded	GΩ, min	Case Grounded	GΩ, min
IEEE 1451.4		IEEE 1451.4	

**This family also includes:**

Model	Sensitivity (mV/g)	Frequency Response (Hz)	Mounting	Operating Temp (°F)
3023AT	10 (-10 to +15%)	1.5 to 10000 (-5 to +15%)	Adhesive	-60 to +250

Refer to the performance specifications of the products in this family for detailed description

**Supplied Accessories:**

1) Accredited calibration certificate (ISO 17025)

**Notes:**

- [1] Measured at 100Hz, 1 Grms per ISA RP 37.2.  
[2] Measure using zero-based straight line method, % of F.S. or any lesser range.  
[3] Do not apply power to this system without current limiting, 20 mA MAX. To do so will destroy the IC charge amplifier.  
[4] In the interest of constant product improvement, we reserve the right to change specifications without notice.

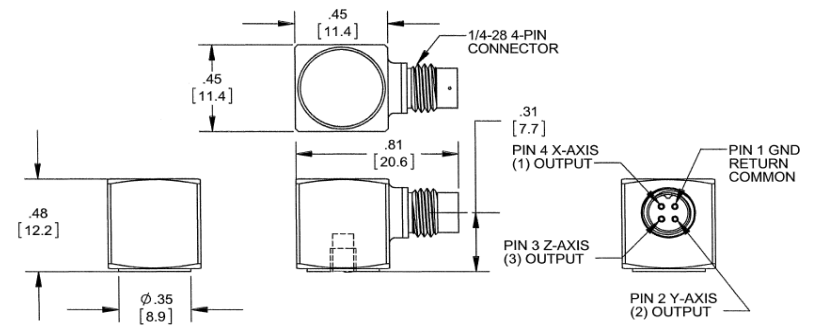
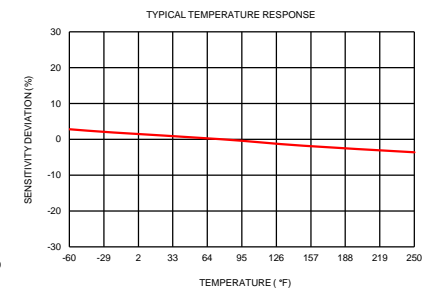
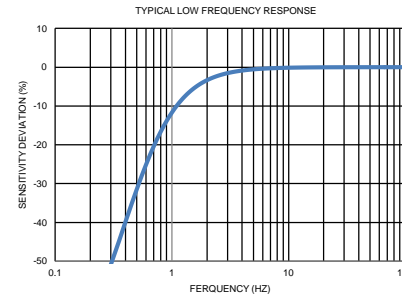

Units on the line drawing are in inches, units in brackets are in millimeters. Refer to 127-3023A1T for more information.



21592 Marilla Street, Chatsworth, California 91311 Phone: 818.700.7818 Fax: 818.700.7880 www.dytran.com  
For permission to reprint this content, please contact info@dytran.com



Presented by: Absolute Gauge Technologies  
sales@absolutegauge.com; www.absolutegauge.com,  
Toronto: 416 754 3168, Montreal: 514 695 5147, Toll Free: 1 888 754 7008