

# MV-CH140-60GM/GC

## 14 MP 1" CMOS GigE Area Scan Camera



**GEN<i>i</i>CAM**

**GigE VISION**

### Introduction

MV-CH140-60GM/GC camera adopts CMOS global sensor to provide high-quality images. It uses GigE interface to transmit non-compressed images in real time, and its max. frame rate can reach 9 fps in full resolution.

### Key Feature

- Supports auto or manual adjustment of gain, exposure time, white balance, LUT, Gamma correction, etc.
- Adopts GigE interface and max. transmission distance of 100 meters without relay.
- Compatible with GigE Vision V2.0 Protocol, GenICam Standard, and third-party software based on the protocol and standard.

### Dimension

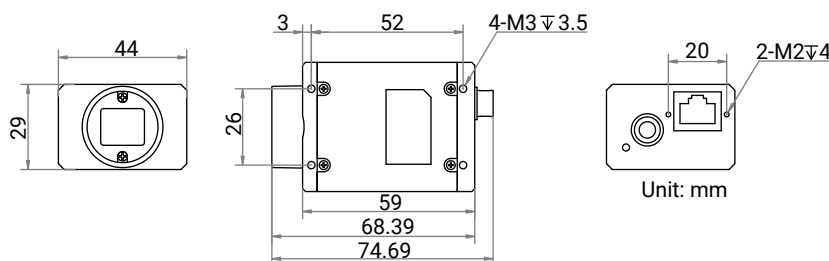

### Available Model

- Mono camera: MV-CH140-60GM
- Color camera: MV-CH140-60GC

### Applicable Industry

Electronic semiconductor, factory automation, logistics code reading, medicine packaging, etc.

### Sensor Quantum Efficiency

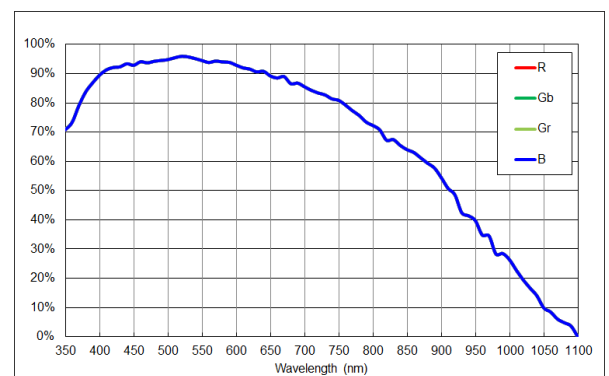

MV-CH140-60GM

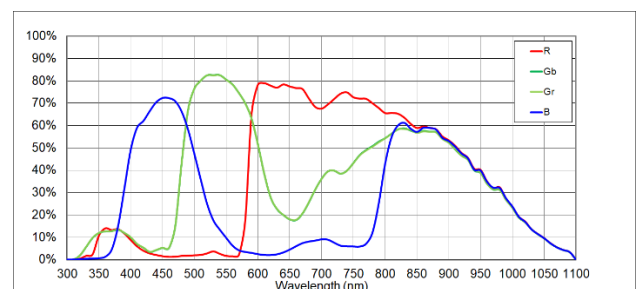

MV-CH140-60GC

## Specification

Model	MV-CH140-60GM	MV-CH140-60GC
<b>Performance</b>		
Sensor type	CMOS, global shutter	
Sensor model	Stacked BSI	
Pixel size	3 μm × 3 μm	
Sensor size	1"	
Resolution	4708 × 2824	
Max. frame rate	9 fps @4708 × 2824 Mono 8	9 fps @4708 × 2824 Bayer GR 8
Dynamic range	56.9 dB	
SNR	41.9 dB	
Gain	0 dB to 24 dB	
Exposure time	80 μs to 10 sec	
Exposure mode	Off/Once/Continuous exposure mode	
Mono/color	Mono	Color
Pixel format	Mono 8/10/10Packed/12/12Packed	Mono 8/10/12, Bayer GR 8/10/10Packed/12/12Packed, YUV422Packed, YUV422_YUYV_Packed, RGB 8, BGR 8
Binning	Supports 1 × 1, 2 × 2	
Decimation	Supports 1 × 1, 2 × 2	
Reverse image	Supports horizontal and vertical reverse image output	
<b>Electrical feature</b>		
Data interface	Gigabit Ethernet, compatible with Fast Ethernet	
Digital I/O	6-pin P7 connector provides power and I/O, including opto-isolated input × 1 (Line 0), opto-isolated output × 1 (Line 1), bi-directional non-isolated I/O × 1 (Line 2).	
Power supply	9 VDC to 24 VDC, supports PoE	
Power consumption	Typ. 3.0 W@12 VDC	Typ. 3.5 W@12 VDC
<b>Mechanical</b>		
Lens mount	C-mount	
Dimension	29 mm × 44 mm × 59 mm (1.1" × 1.7" × 2.3")	
Weight	Approx. 117 g (0.3 lb.)	
Ingress protection	IP40 (under proper lens installation and wiring)	
Temperature	Working temperature: -10 °C to 50 °C (14 °F to 122 °F) Storage temperature: -30 °C to 70 °C (-22 °F to 158 °F)	
Humidity	20% to 95% RH, non-condensing	
<b>General</b>		
Client software	MVS or third-party software meeting with GigE Vision Protocol	
Operating system	32/64-bit Windows XP/7/10, 64-bit Windows 11, 32/64-bit Linux and 64-bit MacOS	
Compatibility	GigE Vision V2.0, GenICam	
Certification	CE, RoHS, KC	